

ANNEX 4

Public

Copy №

Information
Regarding the Tskhinvali preliminary detention facility

The preliminary detention facility of the Ministry of Internal Affairs of the separatist regime (also known as the temporary detention *isolator*) is located in the city of Tskhinvali, on the ground floor of the premises of the de-facto Ministry of Internal Affairs at №5 Khetagurovo Street (see photo), at the following coordinates: 42°13'32.9"N 43°58'24.7"E (42.225800, 43.973520).

The Tskhinvali preliminary detention facility was built in the 1930s (no archive record is available on its architectural plan). It used to be the only correctional penitentiary facility that combined the functions of general regime and strict regime colonies. It is also referred to as the Tskhinvali correctional colony. The facility also served as an investigation *isolator*. The building accommodated both suspects and convicts.

In 2008, there were 9 cells at the penitentiary facility, each designed, according to internal regulations, to accommodate 4 accused persons – however, sometimes more were placed. In 2019, the building underwent comprehensive overhaul and was divided into general and strict regime parts. A canteen was added and the conditions were improved – it is now designed to accommodate 83 people (<https://sova.news/2019/10/23/v-internet-popalo-video-izbieniya-zaklyuchennyh-v-tshinvali/>).

The current chief of the preliminary detention facility is **Vadim Mamiev**.

Igor Pukhaev (born on 26/06/1969), advisor to **Dimitri Sanakoev**, chief of the South Ossetian administration, who served a sentence at the said facility in 2014-2016, is in a position to provide information regarding the *isolator*.

This is presumably what the layout of the preliminary detention facility was like in 2008:

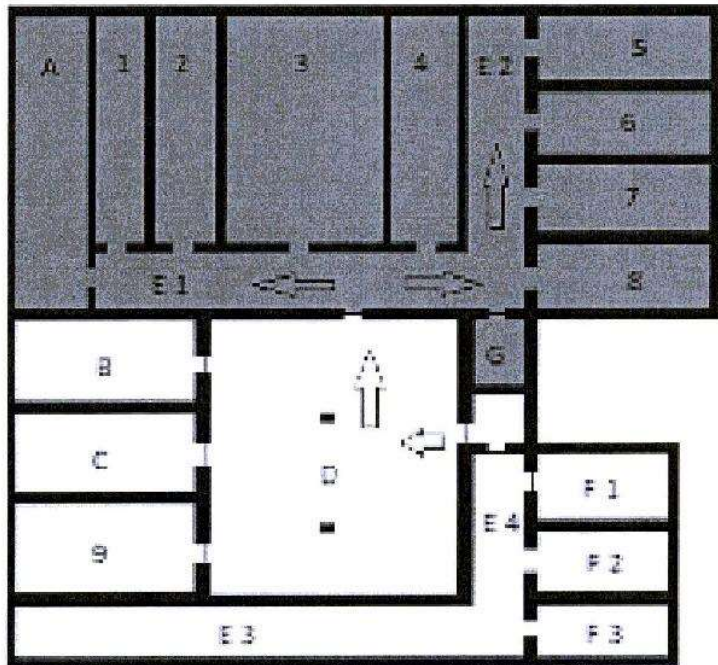

Cell

- №1 – sized 2mX4m
- №2 – sized 2mX4m
- №3 – sized 4mX4m
- №4 – sized 2mX4m
- №5 – sized 1,6mX4m
- №2 – sized 1,6mX4m
- №3 – sized 1,6mX4m
- №4 – sized 1,6mX4m
- № - sized 3mX6m

Corridor

- E1 – sized 2,5mX10m
- E2 – sized 1,5mX5,5m
- E3 – sized 1mX12,5m
- E4 – sized 1mX5,5m

Storage facility

F1 – sized 2mX3m

F2 – sized 2mX3m

F3 – sized 1,5X3m

Guards' room – A, sized 2,5mX6,5m**Sentry post** – B, sized 3mX6m**Medical point** – C, sized 6,5X9m**Exercise yard** – D, sized 6,5mX9m**Restroom** – C, sized 1,5mX2,5m

The guards' room and the cells (№1 to №8 inclusive) are partially located in the basement, 0.5 metre below the level of the exercise yard. The exercise yard and the corridor (E3, E4) are fully covered with steel bar mesh. Cell №9 accommodated Ossetians (presumably a *makurebeli* [literally "observer", an influential prisoner, either unlawfully favoured or tacitly tolerated by the prison administration, who oversees the activities of other inmates] and persons adhering to thieves' [underworld] traditions), who could access the yard directly. The total area is 265m².



OTP/LSU Translation of GEO-OTP-0047-3102

GEO-OTP-0047-5129